

REWITNESSED CORNER FOR STATE OF OREGON - DEPARTMENT OF FORESTRY

Section corner common to Sections 7, 12, 13 and 18, T2N, R7&8W, W.M., Tillamook County, Oregon.

ORIGINAL By Henry Meldrum, August 14, 1891.

17"x12"x9" stone, 12" in ground with 4 notches on South and 2 notches on North sides. Raised mound of stone alongside; found corner stone on north side of pipe.

18" Hemlock bears N51°E 79 lks.; now a 27" badly rotted stub 6 ft. high with portions of backcast scribes visible.

RESTORATION by Louis W. Amort, RE2311, August 15, 1952 (Book 2, page 173, Tillamook County Records).

1 1/2"x36" galvanized iron pipe with 3" bronze cap, 30" in ground, in mound of rock; in place.

36" Noble Fir bears N21°E 26.4 ft.; now a 36" badly rotted uprooted stump, no scribes visible.

42" Noble Fir bears S73°E 50.7 ft.; now a 42" stump with portions of scribes visible on rotted face.

90" Fir snag bears S48 1/2°W 16.1 ft.; now a 90" stump with scribes T2N R8W S13 BT visible.

18" Alder bears N66 1/2°W 75.5 ft.; now a 21" rotten windfall with axe work visible on rotted out face.

REWITNESSED October 21, 1987

Var 21 1/2°E

From above pipe with marks "LS1998 1987" added, and from which a:

12" Hemlock bears N57 3/4°E 40.4 ft. to face; scribed T2NR7WS7BT.

11" Hemlock bears S78°E 20.8 ft. to face; scribed T2NR7WS18BT.

10" Hemlock bears S25°W 13.0 ft. to face; scribed T2NR8WS13BT.

NOTE: Tree has grown together with a 9" Hemlock at the trunk.

16" Hemlock bears N73 1/2°W 10.6 ft. to face; scribed T2NR8WS12 BT.

Metal location poster on new BTs.

Also brass washers marked "LS1998" on new BTs.

Present and witnessed by David B. Buchholz and Clifford R. Foster

Rewitnessed by

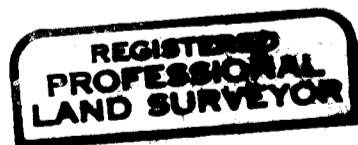

*Anthony J. Klosterman*

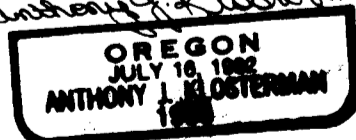

BOOK 6